



# COUPLER

## Assembly & Safety Instructions

FOR AH3/AH4, H-3, H3BOS



**AH3/AH4**  
Adjustable Coupler



**H-3**  
Weld On Coupler

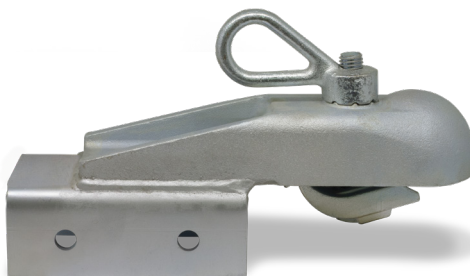

**H3BOS Series**  
Bolt On Coupler

### SAFETY FIRST:

- **DO NOT** substitute regular nuts, loop nuts, or handwheels, for Croft K.C. MO N-3 Loop Nut or K-3 Handwheel.
- **DO NOT** use hex head bolts in place of square head B-3 Bolt.
- **DO NOT** leave out W-3 Washer or S-3 Spring. Check coupler to make sure the C-3 Lip and all parts are in place correctly before use.
- **DO NOT** use a wrench or bar to tighten coupler. Over-tightening strains and wears bolt and nut threads, and may cause the coupler to seize on the ball.  
**HAND-TIGHTEN coupler snug on ball.**

**CROFT TRAILER SUPPLY** - Trailers, Parts, & Service Since 1939  
[www.CroftTrailer.com](http://www.CroftTrailer.com) | (800) 426-8159 | Fax (816) 861-1881



# CAST STEEL COUPLERS

## Assembly/Installation

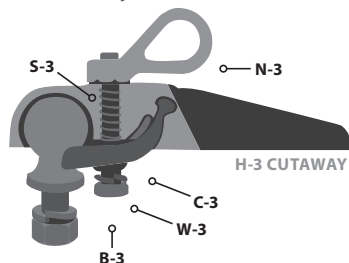

### INSTALL ON BALL:

**Loosen loop nut or handwheel.** The spring will push the lip down. Put coupler socket down on ball. While tightening, feel under coupler to make sure square bolt head is up in the square lip cavity and the lip under the ball head. Press upward on the lip for easy tightening of the loop nut or handwheel.

**Cutaway photos of coupler with parts installed.** Graphic above shows ball in coupler socket and installed parts. Illustration at right shows the sequence and position of parts.

**Install C-3 Lip** in between the ledges inside the coupler body by hooking the rear flat surface over the horizontal ledge, then swing the lip forward. The lip hinges on top of the horizontal ledge and is held by both ledges when swings forward.

**Install S-3 Spring** between the lip and inside of coupler under the bolt hole. Put the **W-3 Washer** on the **B-3 Bolt**, then push the bolt through the lip, spring and body bolt hole. Insure the square head of the bolt fits into the square cavity of the lip. The **W-3 Washer** provides extra spring tension to allow the notches in either the **N-3 Loop Nut** or **K-3 Handwheel Knob** to join and ratchet up and down over the ribs around the body bolt hole.

**Screw either the N-3 Loop Nut or K-3 Handwheel Knob** on the bolt. Note how notches in them join the ribs around the body bolt hole as lip is drawn up.

**No Wrench or Bar Needed to Tighten Nut Down Snug**

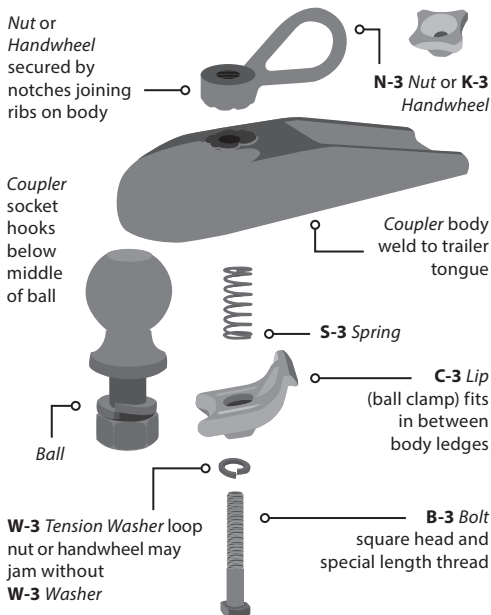

**COUPLER INSTALLATION:** Coupler steel is ASTM A 27-80, Class 65-35. Weld at least the entire bottom edge of both sides with good penetration of both coupler and tongue. Use 1/2" grade 5 bolts with H3BOS series couplers.

**PARTS FUNCTION:** There is a definite safety purpose for each part. Install ALL parts as shown. The body and parts shown comprise a positive locking device in Croft, K.C., MO couplers. The square bolt head cannot turn in the C-3 Lip (ball clamp), the N-3 Loop Nut (or K-3 Handwheel Knob) must turn uphill against gravity and ratchet up and down over the ribs around the bolt hole in order to loosen. Both the W-3 Washer and the S-3 Spring exert pressure down, joining the ribs and notches securely.

**MAINTENANCE:** Oil threads of bolt and loop nut or handwheel periodically. Check ribs on top of coupler and bottom of loop nut or handwheel for wear. Always replace any missing, broken, damaged or worn parts with genuine CROFT, K.C., MO. PARTS ONLY.

**LIMITATIONS ON WARRANTY COVERAGE:** Warrantor has no liability whatsoever and this warranty is null and void if any Croft coupler has been misassembled, assembled with other than genuine Croft parts, or subjected to neglect, negligence, misuse, accident or operated in anyway contrary to the operating and maintenance instructions as specified in the provided Croft Assembly and Safety Instructions for that model coupler and repair kit.